

r.LiNK-Interface

RL-MFD1

Audio-video-input for navigation systems Volkswagen MFD1/RNS-D

AV-input to connect any AV-source to the factory navigation system

Contents

1. Prior to installation

- 1.1. Delivery contents
- 1.2. Check compatibility of vehicle and accessories

2. Connection schema

3. Installation

- 3.1. Interconnecting Interface-box, harness and head-unit
- 3.2. Connection to AV-source or after-market rear-view camera

4. Specifications

5. Technical Support

Legal Information

By law, watching moving pictures while driving is prohibited, the driver must not be distracted. We do not accept any liability for material damage or personal injury resulting, directly or indirectly, from installation or operation of this product. This product should only be used while standing or to display fixed menus or rear-view-camera video when the vehicle is moving, for example the MP3 menu for DVD upgrades.

Changes/updates of the vehicle's software can cause malfunctions of the interface. We offer free software-updates for our interfaces for one year after purchase. To receive a free update, the interface must be sent in at own cost. Labor cost for and other expenses involved with the software-updates will not be refunded.

1. Prior to installation

Read the manual prior to installation. Technical knowledge is necessary for installation. The place of installation must be free of moisture and away from heat sources.

1.1. Delivery contents

Take down the SW-version and HW-version of the interface boxes, and store this manual for support purposes.

Interface-box
RLC-M02
HW _____ SW _____



1.2. Check compatibility of vehicle and accessories

Requirements

<i>Vehicle</i>	Volkswagen
<i>Navigation</i>	newer MFD1(4:3) navigation

Limitations

<i>Factory-TV-tuner</i>	Must NOT be installed.
<i>Factory-rear-view-camera</i>	Must NOT be installed.
<i>Video-source</i>	Interface is initialized to PAL.

2. Connection schema

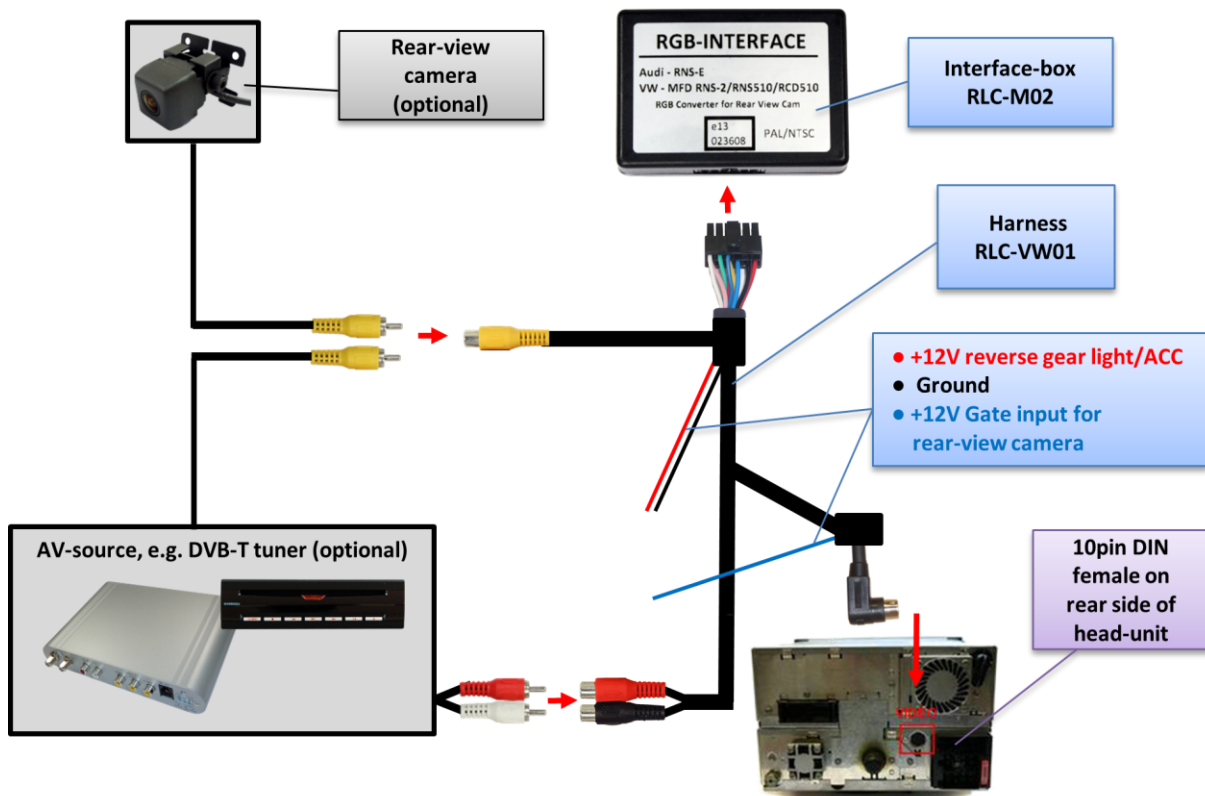

3. Installation

Switch off ignition and disconnect the vehicle's battery! If according to factory rules disconnecting the battery has to be avoided, it is usually sufficient to put the vehicle in sleep-mode. In case the sleep-mode does not show success, disconnect the battery with a resistor lead.

Place of installation is behind the head-unit.

3.1. Interconnecting Interface-Box, harness and head-unit

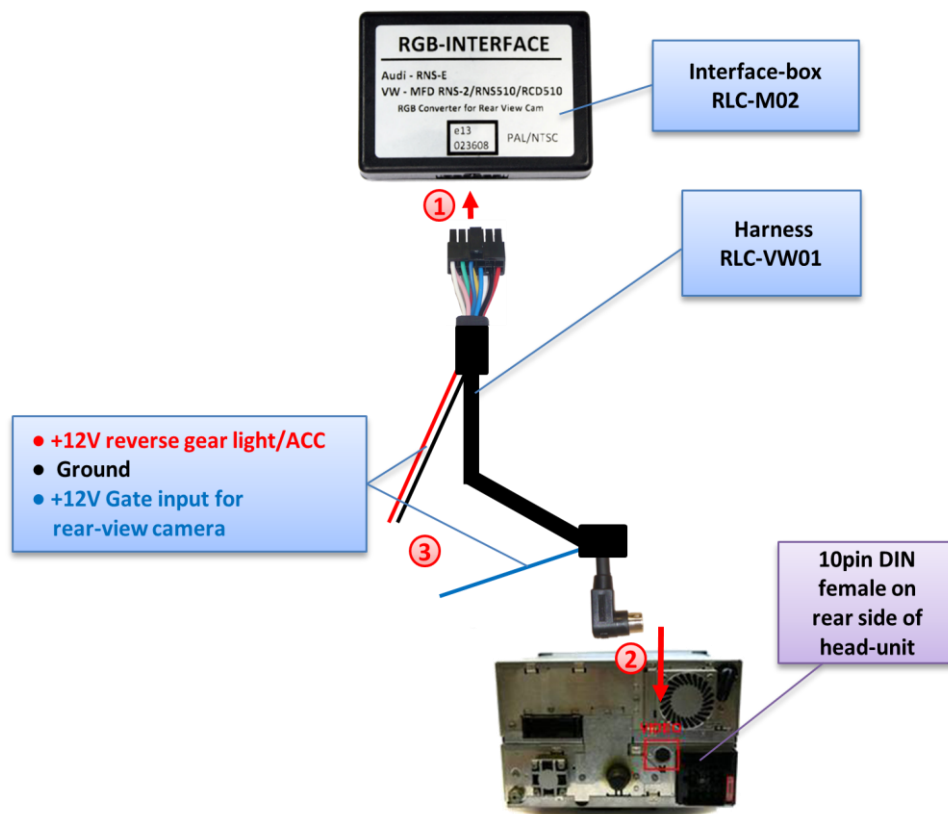

- ① Plug harness RLC-VW01 into 12pin Molex of Interface-box RLC-M02.
- ② Plug male 10pin DIN-connector of RLC-VW01 into female 10pin DIN-connector of head-unit.
- ③ If connecting an AV-source:
Connect red cable of harness RLC-VW01 to +12V ACC and black cable of harness RLC-VW02 to ground. **NOT** connect the blue cable.
If connecting a rear-view camera:
Connect red and blue cable of harness RLC-VW01 to +12V reverse gear light (we suggest to connect through relais to avoid signal noise) and black cable of harness RLC-VW02 to ground.

Note: If the female 10pin DIN-connector of the head-unit is already occupied, the vehicle has a factory TV-tuner. In this case it must be uninstalled: disconnect the male 10pin DIN-connector of the factory harness and disconnect all wires from the factory TV-tuner.

3.2. Connections to AV-source or after-market rear-view camera

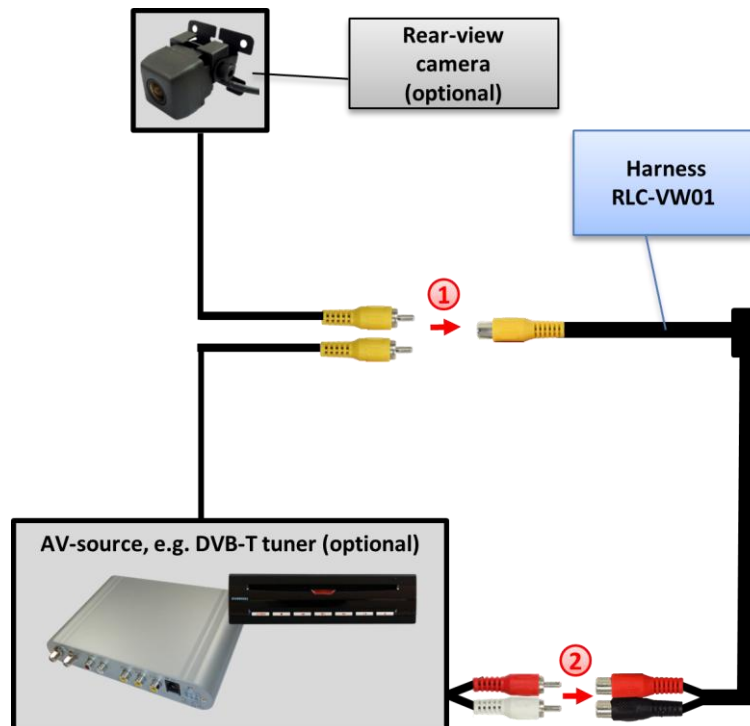

- ① Connect the video RCA of the AV-source or the after-market rear-view camera to female video RCA-connector of harness RLC-VW01.
- ② If connecting an AV-Source, connect the audio RCA of the AV-source to female audio RCA-connector of harness RLC-VW01.

Note: The interface is initialized to PAL. Cut and isolate both ends of the green cable of harness RLC-VW01 if you want to connect a NTSC-source.

4. Specifications

Operation voltage	10.5 – 14.8V DC
Stand-by power drain	0mA
Operation power drain	200mA
Power consumption	2.8W
Temperature range	-30°C to +80°C
Weight	53g
Measurements (box only) B x H x T	72 x 23 x 50mm

CE  12V DC

5. Technical Support

Caraudio-Systems Vertriebs GmbH
manufacturer/distribution
Rheinhorststr. 22
D-67071 Ludwigshafen am Rhein

NavLinkz GmbH
corporate sales/tech dealer-support
Eurotec-Ring 45
D-47445 Moers

phone +49 180 3 907050
email support@caraudio-systems.de

Legal disclaimer: Mentioned company and trademarks, as well as product names/codes are registered trademarks ® of their corresponding legal owners.