



## Volkswagen LOC (Line Output Converter) AXLOC-VW2 (for Non-Amplified Vehicles) 2016-Up

Visit [AxxessInterfaces.com](http://AxxessInterfaces.com) for more detailed information about the product and up-to-date vehicle specific applications.

- Designed to provide (2) channels of low-level audio output from the factory system.
- Allows for the installation of an amplifier for speakers or subwoofers.
- Gain Controller included to adjust the overall output.
- 12v-500mA remote wire activated with signal sense.
- 55-watts per channel.

**Note:** A single pole double throw (SPDT) relay is recommended when installing multiple amplifiers.

### APPLICATIONS

#### Volkswagen

Beetle	2016-Up
Golf	2015-Up
Jetta	2016-Up
Passat	2016-Up
Tiguan	2016-Up

For dash disassembly instructions, refer to [metraonline.com](http://metraonline.com). Enter the year, make, and model of the vehicle in the **Vehicle Fit Guide** for **Radio Install Kits**.

### TABLE OF CONTENTS

Applications.....	1
Installation .....	2
Diagram.....	3

### TOOLS REQUIRED

- Crimping tool and connectors, or solder gun, solder, and heat shrink
- Tape • Wire cutter • Zip-ties

### KIT COMPONENTS

- AXLOC-VW2 Wiring Harness
- Gain Controller
- 12v-500mA Remote Wire
- Auxiliary Cable

**ATTENTION:** With the key out of the ignition, disconnect the negative battery terminal before installing this product. Ensure that all installation connections, especially the air bag indicator lights, are plugged in before reconnecting the battery or cycling the ignition to test this product.  
**NOTE:** Refer also to the instructions included with the aftermarket accessory before installing this device.

## INSTALLATION

1. Disconnect the harness from the factory tuner and install the **AXLOC-VW2 harness** provided with this kit.
2. Mount the gain controller in a suitable location, and connect the auxiliary cable to the **BASS KNOB**, then to the Gain Connector of the **AXLOC harness**.
3. Install the aftermarket amplifier and run an RCA pair (sold separately) to the line converter.
4. Connect the remote wire, plug in the device and secure all connections prior to testing.

**NOTE:** *If the vehicle is equipped with active noise cancellation microphones (ANC), it is recommended that they are disabled to prevent potential noise when installing subwoofers.*

# DIAGRAM

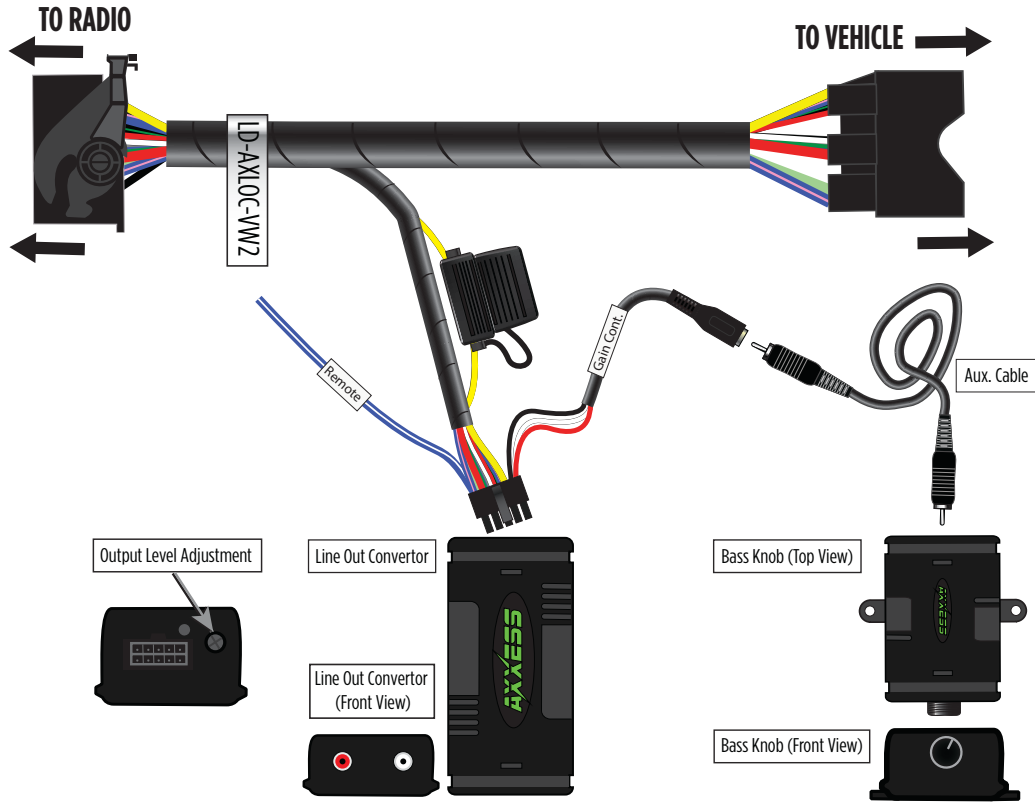



# AXLOC-VW2

INSTALLATION INSTRUCTIONS



Having difficulties? We're here to help.



Contact our Tech Support line at:

**386-257-1187**



Or via email at:

[techsupport@metra-autosound.com](mailto:techsupport@metra-autosound.com)

### Tech Support Hours (Eastern Standard Time)

Monday - Friday: 9:00 AM - 7:00 PM

Saturday: 10:00 AM - 7:00 PM

Sunday: 10:00 AM - 4:00 PM



### **KNOWLEDGE IS POWER**

Enhance your installation and fabrication skills by enrolling in the most recognized and respected mobile electronics school in our industry. Log onto [www.installerinstitute.edu](http://www.installerinstitute.edu) or call 386-672-5771 for more information and take steps toward a better tomorrow.



**Metra recommends MECP  
certified technicians**